

PLAT OF SURVEY
UNIT 33
SOUTH SHORE CLUB ON LAKE GENEVA
A CONDOMINIUM
REC. IN CAB. A, SLIDE 394, DOC. NO. 500527

LOCATED IN CERTIFIED SURVEY MAP 2631
RECORDED IN VOL. 13 OF CERTIFIED SURVEYS
ON PAGE 171, AS DOCUMENT NUMBER 311927
BEING IN ALL 1/4'S OF NE 1/4 OF
SECTION 18, TOWN 1 NORTH, RANGE 17 EAST
WALWORTH COUNTY, WISCONSIN

UNIT 35

SAN. MH
RIM=887.7
IE=872.6(W&E)
IE=874.5(S)

EXISTING SANITARY SEWER

WINDOW WELL

STONE RETAINING WALL
UNDER CONSTRUCTION

CONCRETE PATIO

CHIMNEY

BRICK PATIO

AS-BUILT FOUNDATION
FOR UNIT 34

SAN. MH
RIM=887.9

BRICK WALK

STONE STEPS

38.5'

BRICK DRIVE

VALVE BOX

VALVE BOX

WATER VALV

EAST LAKESIDE LANE
66' WIDE PRIVATE ROADWAY

EXISTING WATERMAIN

SAN. MH
RIM=886.5
IE=876.6

UTILITY BOXES

TRANS. BOX

CITY BOX

IRRIGATION VALVES

IRRIGATION VALVES

IRRIGATION VALVES

SAN. MH
RIM=889.4
IE=879.5

EXISTING EDGE OF BRICK

SAN. MH
RIM=892.0
IE=878.6

CONCRETE RETAINMENT WALL

BRICK

BRICK

BRICK

BRICK

BRICK

BRICK

BRICK

BRICK

BRICK

BRICK

BRICK

BRICK

BRICK

BRICK

BRICK

BRICK

BRICK

BRICK

BRICK

BRICK

BRICK

BRICK

BRICK

BRICK

BRICK

BRICK

BRICK

BRICK

BRICK

BRICK

BRICK

BRICK

BRICK

BRICK

BRICK

UNIT 33
AS BUILT FOUNDATION
(FIELD LOCATED 6/11/2008)

DECK

STONE RETAINMENT WALL

CHIMNEY

STONE STOOP

21.0'

42.3'

22.3'

2.0'

17.4'

52.0'

20.0'

22.7'

24.7'

22.7'

20.2'

20.0'

1.5'

1.5'

2.0'

2.0'

2.0'

2.0'

2.0'

2.0'

2.0'

2.0'

AC UNITS

GENERATOR PAD

BRICK DRIVE

IRRIGATION VALVES

IRRIGATION VALVES

IRRIGATION VALVES

IRRIGATION VALVES

IRRIGATION VALVES

IRRIGATION VALVES

IRRIGATION VALVES

IRRIGATION VALVES

IRRIGATION VALVES

IRRIGATION VALVES

IRRIGATION VALVES

IRRIGATION VALVES

IRRIGATION VALVES

IRRIGATION VALVES

IRRIGATION VALVES

IRRIGATION VALVES

IRRIGATION VALVES

IRRIGATION VALVES

IRRIGATION VALVES

UNIT 32

NOTE: UNIT 33 IS SUBJECT TO EASEMENTS, RESTRICTIONS AND COVENANTS RECORDED IN THE
DECLARATION FOR SOUTH SHORE CLUB ON LAKE GENEVA AND SUBSEQUENT ADDITIONS.

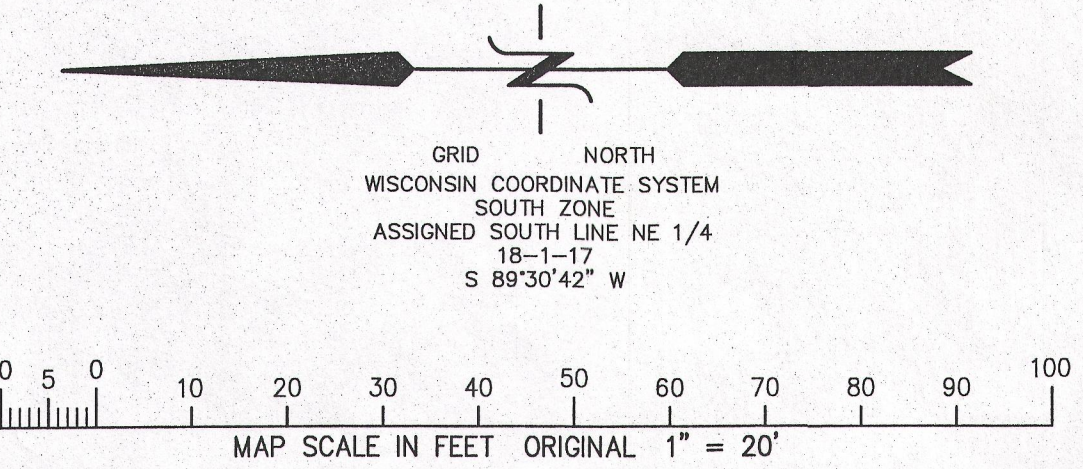

NOTE: COPIES OF THIS MAP TO WHICH THE FOLLOWING CERTIFICATE WILL APPLY SHOW
THE SURVEYOR'S ORIGINAL SEAL AND SIGNATURE IN RED INK. COPIES BY ANY OTHER
MEANS MAY HAVE ALTERATIONS WHICH DO NOT REPRESENT THE SURVEYOR'S WORK
PRODUCT.

I HEREBY CERTIFY THAT THE ABOVE DESCRIBED PROPERTY HAS BEEN SURVEYED UNDER
MY DIRECTION AND THAT THE ABOVE MAP IS A TRUE REPRESENTATION THEREOF AND
SHOWS THE SIZE AND LOCATION OF THE PROPERTY, ITS EXTERIOR BOUNDARIES, THE
LOCATION OF ALL VISIBLE STRUCTURES, AND DIMENSIONS OF ALL PRINCIPLE
BUILDINGS THEREON, BOUNDARY FENCES, APPARENT EASEMENTS, ROADWAYS, AND
VISIBLE ENCROACHMENTS, IF ANY. THIS SURVEY IS MADE FOR THE USE OF THE
PRESENT OWNERS OF THE PROPERTY, AND ALSO THOSE WHO PURCHASE, MORTGAGE, OR
GUARANTEE THE TITLE THERETO WITHIN ONE YEAR FROM THE DATE HEREOF.

DATED: DECEMBER 3, 2014

Peter S. Gordon
PETER S. GORDON

RECEIVED
JAN 6 2015
By *Jan*

WISCONSIN
PETER S. GORDON
S-2101
ELKHORN, WI
LAND SURVEYOR

WORK ORDERED BY -
GENEVA LAKEFRONT REALTY
49 WEST GENEVA STREET
WILLIAMS BAY, WI 53191

FARRIS, HANSEN & ASSOCIATES, INC.
ENGINEERING - ARCHITECTURE - SURVEYING
7 RIDGWAY COURT P.O. BOX 437
ELKHORN, WISCONSIN 53121
OFFICE: (262) 723-2098 FAX: (262) 723-5886

REVISIONS

PROJECT NO.
4161.33
DATE:
10/20/03
SHEET NO.
1 OF 1

I88c-33

117-3732

X:\Projects\4161\NDV_LOTS\Lot_33\Draw\TITLE2014